

D-Code Urinal # 082930..00 / 082930..07

| < 305 mm > |

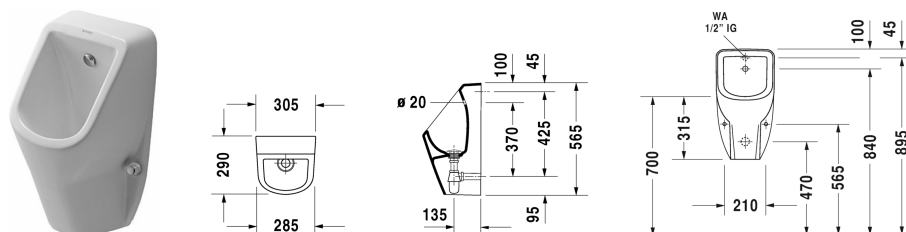

Urinal	Dimension	Weight	Order number
concealed inlet, rimless, for 1/2" connection, includes jet nozzle, inlet-set, waste, bottle trap Ø 32 mm and fixings			
Colors			
00 White Alpin 20 HygieneGlaze (an antibacterial ceramic glaze that provides almost indefinite effectiveness)			
Variant			
model without fly	305 x 290 mm	14.600 kilogram	082930..00
model with fly	305 x 290 mm	14.600 kilogram	082930..07
Infobox			
In combination with adjustable in-wall flushometers, When using GEBERIT pre-wall carriers model range Duofix # 111.616 / Kombifix # 457.611 / GIS # 461.621, mandatory in combination with inlet adapter # 242.042.00.1 for 1/2" inlet connection			

All drawings contain the necessary measurements which are subject to standard tolerances. They are stated in mm and are non-binding. Exact measurements, in particular for customised installation scenarios, can only be taken from the finished ceramic piece.